



LED LOWBAY
I-VALO 6721LED & 6741LED

NEW GENERATION

6721LED Luminaire

BETTER AMBIENT TEMPERATURE RANGE

HIGHER LUMEN OUTPUT
WITH RELIABLE, TOP QUALITY LED CHIPS AND DRIVER

EASILY RETROFITTED



6721LED

Light source	3 x LED MODULE	I-VALO GUARANTEES THE PERFORMANCE VALUES IN THE GIVEN AMBIENT TEMPERATURE RANGE
Ta class	-25°C... +55°C	
Input power	54 W	
Colour temperature	4,000 K	
Lumen output	7,100 lm with PMMA, 6,900 lm with frosted glass	
Efficacy of the luminaire	139 lm/W (PMMA), 135 lm/W (glass)	
Ingress protection	IP65	
Cover material	Satin coated acrylic plate (PMMA) or tempered safety glass (frosted)	
Connection	Cable with a plug 1.5 m or cable glands -o- 5 x 2.5 mm ² + 2 x 2.5 mm ²	
Control	DALI-2	
Frequency	0/50/60 Hz	
Voltage	220 - 240 V	
Inrush current I _{peak}		
(A) Δt @ I _{peak} = 50% (s)	25 A / 280 μs (see table on page 7)	
Efficacy factor	≥0,96	
Weight	~6	



A photograph of an industrial facility, likely a power plant or boiler room, featuring a complex network of large, polished silver pipes and ductwork. The ceiling is high, and several long, rectangular LED luminaire fixtures are mounted on a metal grid structure, illuminating the space. The floor is covered with a grey metal grating. The overall atmosphere is clean and industrial.

LED luminaire for low and medium heights

The luminaire is suitable for applications such as warehouses, ground floors, power plants and boilers, corridors, stairwells and maintenance platforms in pulp and paper mills, and parking areas. This new luminaire with the latest LED-technique is a compact and durable luminaire for the general lighting of low and medium high spaces.

6741LED Luminaire



6741LED

Light source	4 x LED MODULE	I-VALO GUARANTEES THE PERFORMANCE VALUES IN THE GIVEN AMBIENT TEMPERATURE RANGE
Ta class	-25°C... +50°C	
Input power	71 W	
Colour temperature	4,000 K	
Lumen output	9,000 lm with PMMA, 8,800 lm with frosted glass	
Efficacy of the luminaire	127 lm/W (PMMA), 124 lm/W (glass)	
Ingress protection	IP65	
Cover material	Satin coated acrylic plate (PMMA) or tempered safety glass (frosted)	
Connection	Cable with a plug 1.5 m or cable glands -o- 5 x 2.5 mm ² + 2 x 2.5 mm ²	
Control	DALI-2	
Frequency	0/50/60 Hz	
Voltage	220 - 240 V	
Inrush current Ipeak (A) Δt @Ipeak = 50% (s)	25 A /280 μs (see table on page 7)	
Efficacy factor	≥0,97	
Weight	~6	



A photograph of an industrial facility, likely a factory or processing plant. The scene is filled with complex machinery, including large yellow and black units, and a dense network of silver metal pipes and conduits. The lighting is bright, with several overhead lights visible. In the foreground, there are green and yellow safety railings. The overall atmosphere is one of a modern, well-maintained industrial environment.

I-VALO filtering technique

6721LED and 6741LED are both equipped with an I-VALO FILTERING technique that guarantees a long product lifetime by purifying the pressure balancing air flowing into the luminaire. The luminaire retains its luminosity even in difficult conditions.

LED Retrofit



we are proud to ensure that the most **UP-TO-DATE LED technology** is always available - **even in the future**

With the Retrofit package you can easily ensure an even longer lifetime for your products. The package is suitable for existing I-VALO HID lowbay luminaires, as well as for first-generation 6721LED luminaires. **SAVE ENERGY, SAVE MONEY, BE ECOLOGICAL**

The Retrofit -package includes the driver already-attached!



3 LED MODULE PACKAGE

4 LED MODULE PACKAGE

EASY TO RETROFIT;

- just open the latches and change the LED module
- it only takes a few minutes!



Article numbers

LUMINAIRES

Item No	Connection	Input power	Ta Class	Luminous flux	Cover material
6721.008.V3LM11	-o- 5 x 2.5 mm ² + 2 x 2.5 mm ²	54 W	-25°C... +55°C	7,100 lm	PMMA
6721.408.V3LM11	Cable with a plug 1.5 m	54 W	-25°C... +55°C	7,100 lm	PMMA
6721.005.V3LM11	-o- 5 x 2.5 mm ² + 2 x 2.5 mm ²	54 W	-25°C... +55°C	6,900 lm	Frosted glass
6721.405.V3LM11	Cable with a plug 1.5 m	54 W	-25°C... +55°C	6,900 lm	Frosted glass
6741.008.V3LM11	-o- 5 x 2.5 mm ² + 2 x 2.5 mm ²	71 W	-25°C... +50°C	9,000 lm	PMMA
6741.408.V3LM11	Cable with a plug 1.5 m	71 W	-25°C... +50°C	9,000 lm	PMMA
6741.005.V3LM11	-o- 5 x 2.5 mm ² + 2 x 2.5 mm ²	71 W	-25°C... +50°C	8,800 lm	Frosted glass
6741.405.V3LM11	Cable with a plug 1.5 m	71 W	-25°C... +50°C	8,800 lm	Frosted glass

RETROFIT PACKAGES

Item No	Input power	Ta Class	Weight
6721.200.V3LM11	54 W	-20°C... +45°C	1.4 kg
6741.200.V3LM11	71 W	-25°C... +35°C	1.4 kg

This update package is suitable for I-Valo HID lowbay luminaires 6111, 6121, 6201, 6211, 6221 and 6301, as well as for first generation 6721LED luminaires.

Luminaires per circuit breaker

LUMINAIRE	B10 A	B16 A	C10 A	C16 A
6721LED / 6741LED	13	24	19	36

Light distribution

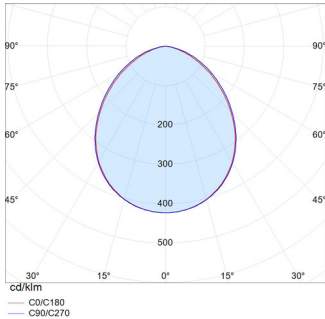

6721.405.V3.LM11
54 W
FROSTED GLAS

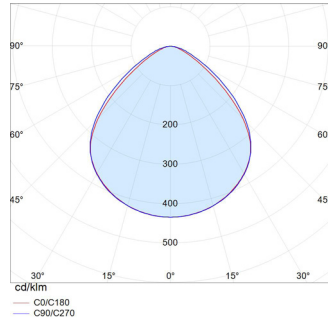

6721.408.V3.LM11
54 W
SATIN COATED ACRYLIC

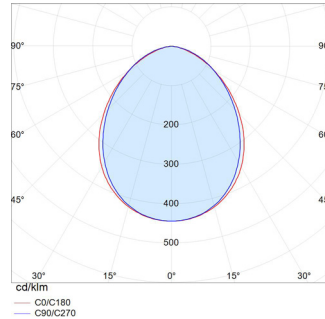

6741.405.V3.LM11
71 W
FROSTED GLAS

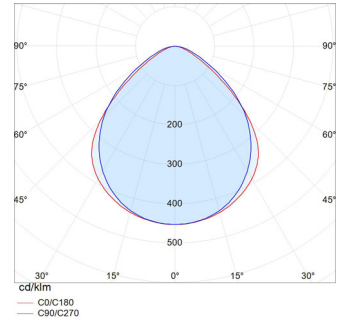

6741.408.V3.LM11
71 W
SATIN COATED ACRYLIC

Dimensions

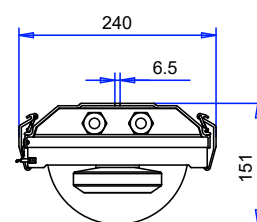
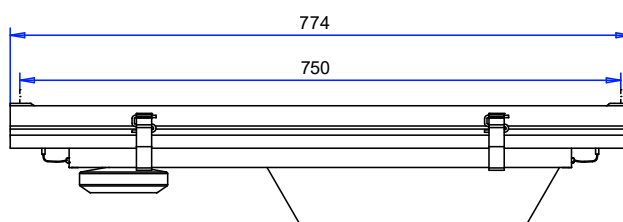
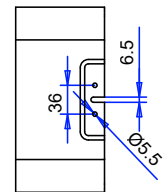
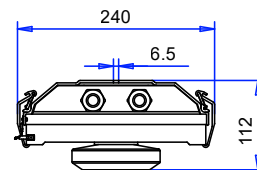
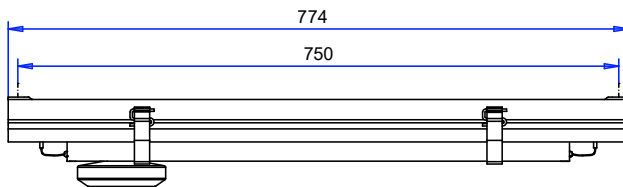



EXCELLENT LIGHT QUALITY

A Pleasant, neutral white light achieved with **excellent optics** and the **best led chips** available provides **even light distribution and thus perfect general lighting**. Superb light quality ensures high **work efficiency** and **productivity, occupational safety** and, **ultimately, well-being**.

Technical characteristics

ROBUST ALUMINIUM STRUCTURE,
covered with polyester coating,
which effectively protects the luminaire from corrosion

EASY-TO-OPEN closing latches
made of polyester-coated aluminium

HIGH QUALITY SILICONE RUBBER GASKETS,
mass tested for luminaire use

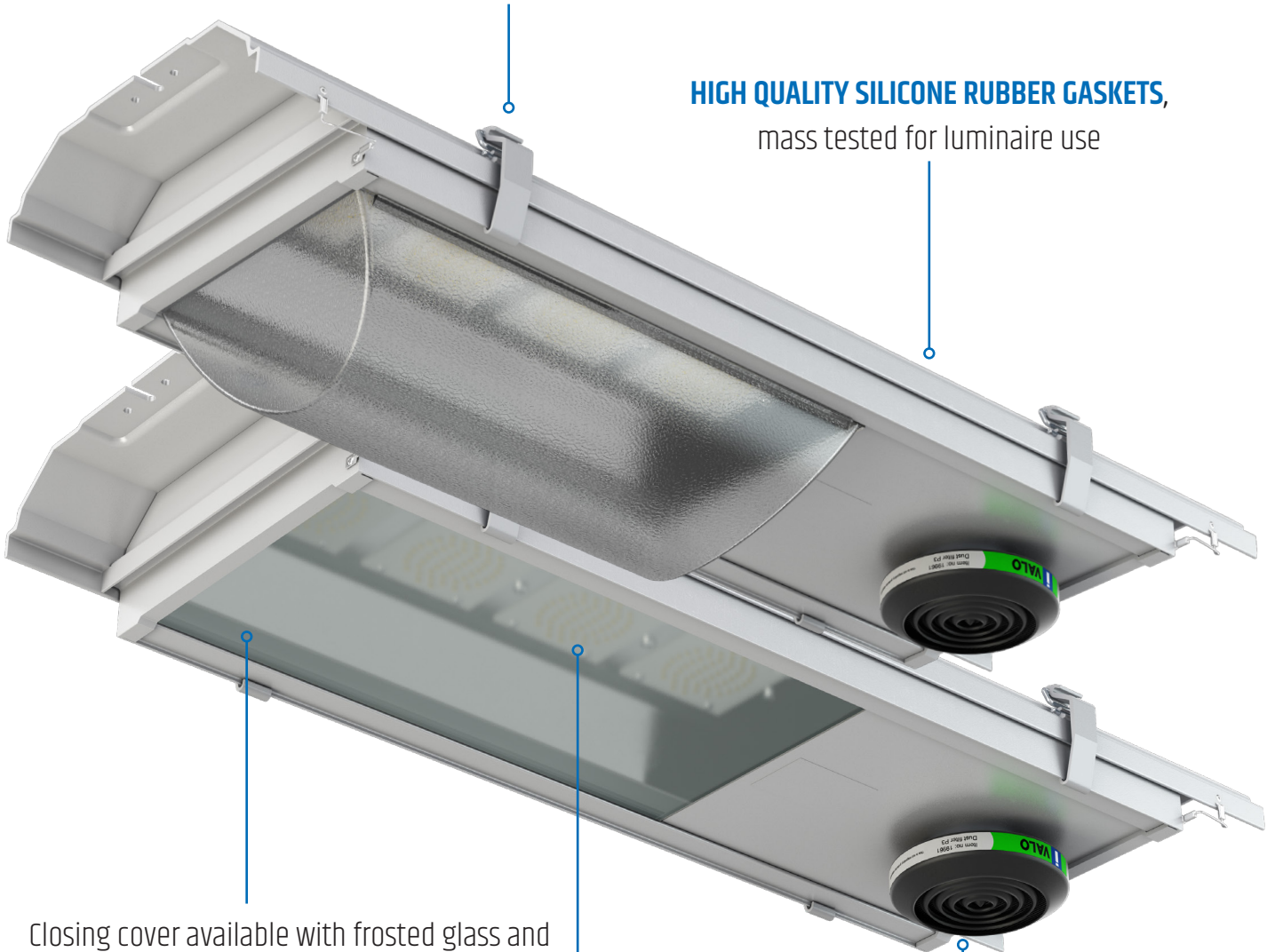

Closing cover available with frosted glass and
satin coated acrylic plate (PMMA)
> **EXCELLENT GLARE CONTROL**

EASILY REPLACEABLE LED MODULE
> **ENSURES UPDATE / RETROFIT POSSIBILITY,**
EVEN IN THE FUTURE

REPLACEABLE FILTER which may be select-
ed according to application requirements
> balances the pressure and air flow
> keeps the inside of the luminaire clean
> **ENSURES LONG PRODUCT LIFETIME**



I-VALO QUALITY - THE BEST THERE IS

- Products made of **the best possible quality components**
- **Long product lifecycle** - the luminaire is also upgradable in the future
- **Versatile mounting possibilities** with a wide selection of mounting brackets
- **High quality finish** - assembled with top quality workmanship in Finland



14500 Iittala, FINLAND
Tel. +358 (0)10 501 3000

info@i-valo.com

www.i-valo.com